

# CFT-201-CC-SS



## FEATURES

- 300 lbs. [136 kg] weight capacity
- Effortless opening and closing of the door with the Catch 'N' Close Closing System (for doors wider than 30 in [762 mm])
- Delrin wheels and precision ball bearings provide smooth and quiet door operation
- Cycle tested for up to 150,000 cycles without fail
- ADA Compliant (Barrier-free) design
- Also available in black (CFT-201-CC-BP)



## COMPLETE 1 DOOR KIT BREAKDOWN



**1 - CFT-200-SS Flat Track**  
x length based on kit size (e.g. 72 in [1829 mm] kit for 36 in [914 mm] wide door)



**CFT-222-WB-SS Wall Mount Brackets**  
quantity dependent on track length  
complete with 5/16-18 flat head socket lag screws and expansion shields



**2 - CFT-201-SS Top Mount Hangers**  
complete with anti-lift and custom mounting screws



**2 - CFT-210-SS Shock Absorbing Stops**  
clamp around flat track



**1 - CFT-200-CC-SS Catch 'N' Close 1 Door Hardware**  
complete with mounting bar, closing devices, anti-lift triggers and shorter wall mount brackets

- CC-75** for doors up to 75 lbs. [34 kg]
- CC-1** for doors up to 150 lbs. [68 kg]
- CC-2** for doors up to 200 lbs. [90 kg]
- CC-3** for doors up to 300 lbs. [136 kg]



**1 - C-914 Aluminum Guide Channel**  
x length based on kit size (e.g. 36 in [914 mm] guide channel for 72 in [1829 mm] kit)

**1 - C-913 Floor Guide**  
complete with screws

## OPTIONAL

### Door Locks & Pulls



### Notes:

Door thickness

Baseboard/trim thickness, if applicable

Customer Name

Job No./Name

Date

Provided By

Notes

# CFT-201-CC-SS

## COMPLETE ELEVATION VIEW

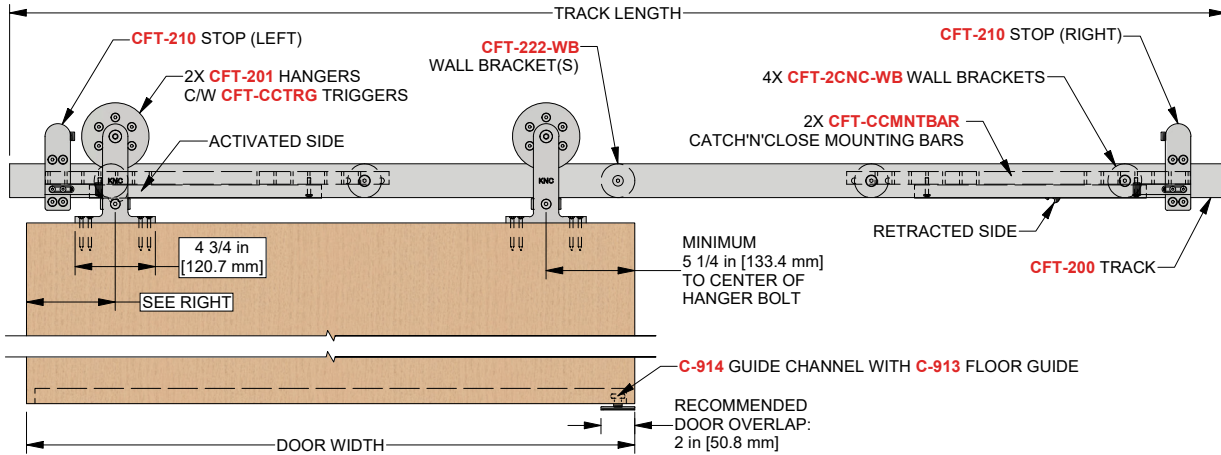

## PRODUCT DIMENSIONS

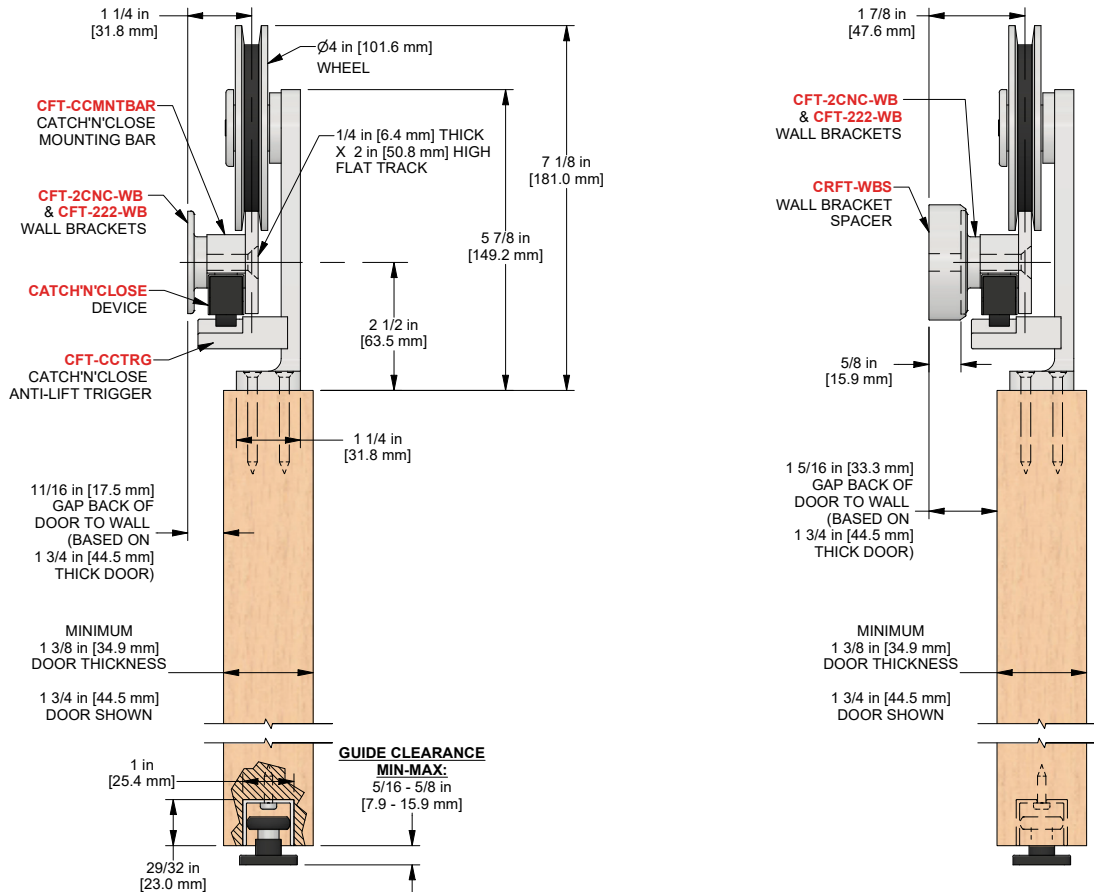

Installation  
Instructions



Customer Name	Job No./Name	Date	Provided By
---------------	--------------	------	-------------

### Notes