

C-94BL-CT Security Lockset

Installation Instructions

Specifications

Case: Heavy gauge wrought
Armor Front: Brass, bronze, stainless
Cam: See details on right
Door Thickness: 1 3/4 in [44.5 mm]

Note: Cylinder will not sit flush with 1 3/8 in [34.9 mm] doors.

Cam Required: B520-233

Dimensions
W = 1.000 in [25.4 mm]
X = 0.232 in [5.9 mm]
Y = 0.729 in [18.5 mm]
Z = 0.694 in [17.6 mm]

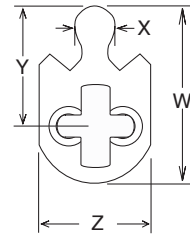

Included Components

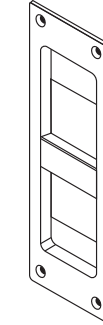
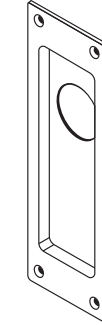
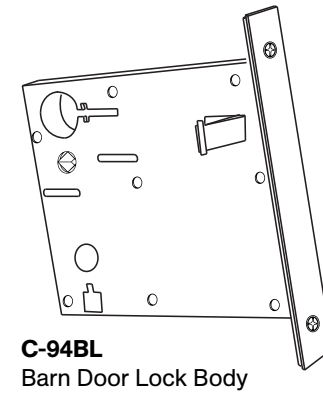

Cylinder
1 in Diameter hole x 1 in Depth.
5-PIN Schlage "C" Key Way (will sit flush with door)

Not to scale

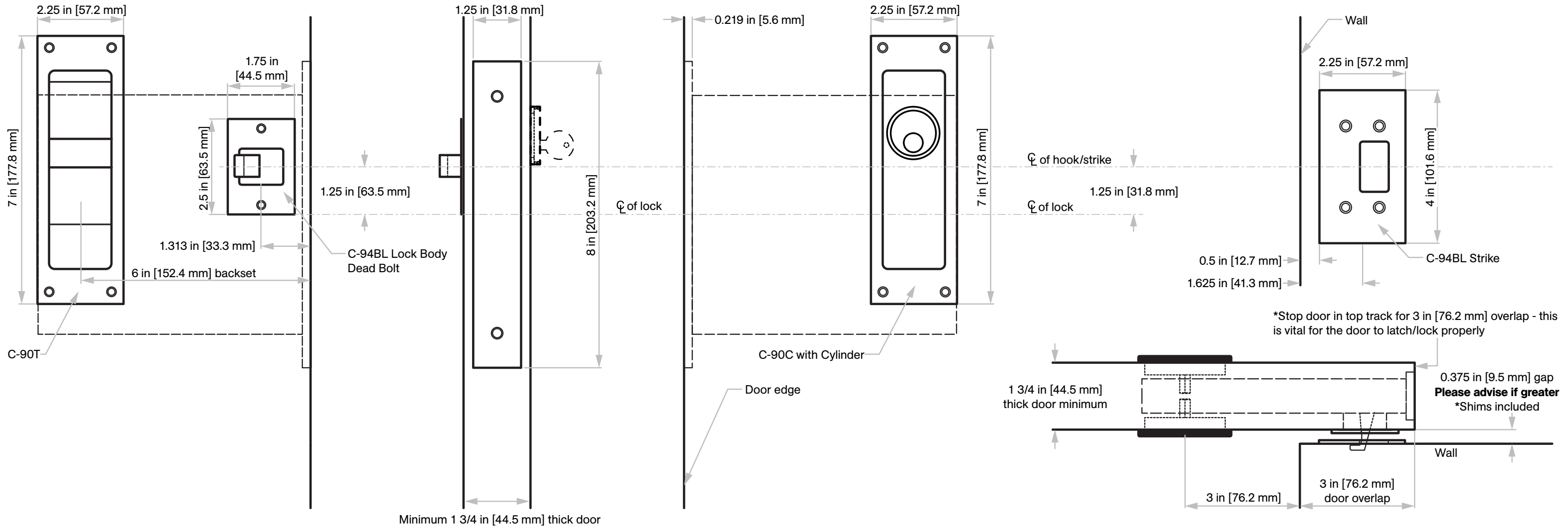

Note: Door size = opening width plus 6 in [152.4 mm]
Example: 40 in [1016 mm] opening + 6 in [152.4 mm] = 46 in [1168.4 mm] wide door

Door Prep Template

Not to scale

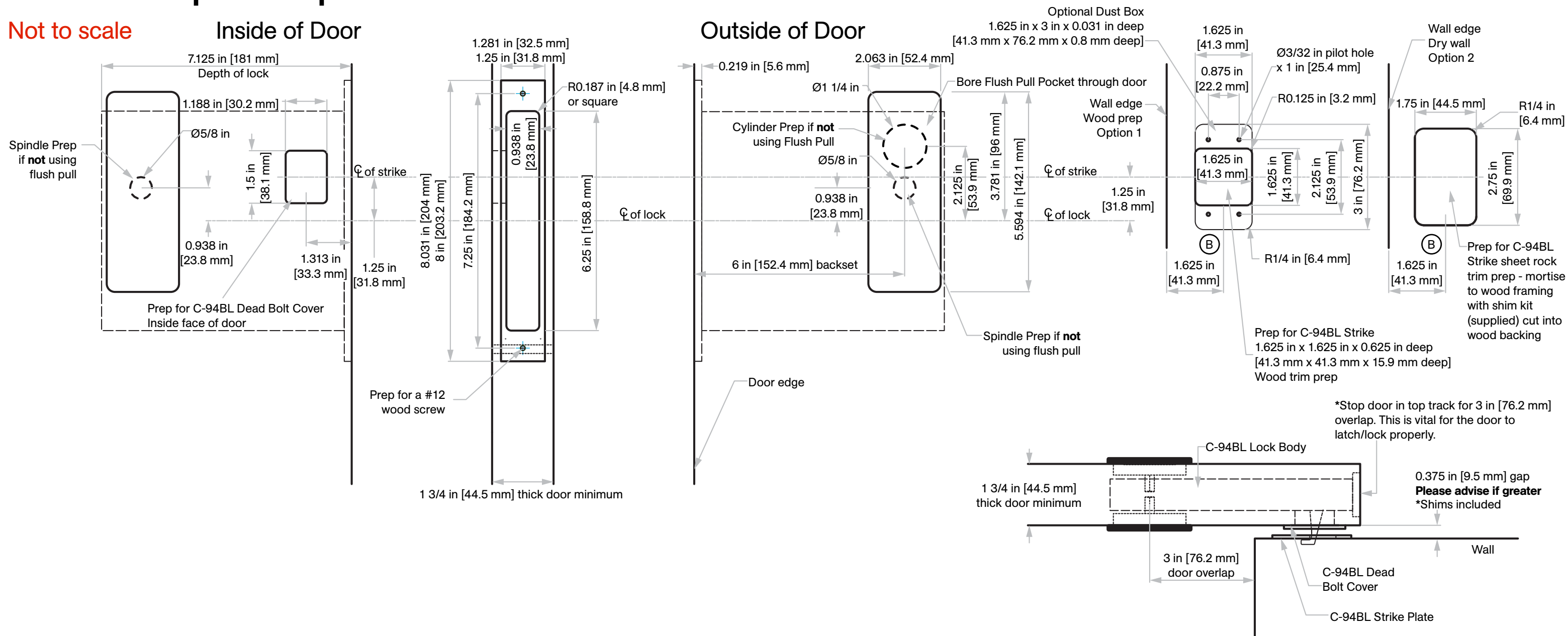

1 Expose screws
Rotate thumb turn 90 degrees to project bolt and expose the two bolt screws



2 Remove bolt from lock body
Extend the bolt and loosen screws without removing them and remove bolt assembly from the lock



3 Insert lock into door
Insert lock into door
Loosen insert mounting screws



4 Reattach bolt
Slightly rotate loose thumb turn to make lock body screws visible
Reinstall bolt assembly by aligning screw holes
Tighten screws
Use thumb turn to fit bolt assembly back in



5 Install armor front
Secure lock in door by tightening screws into door
Install armor front onto basefront



6 Mount cuff
Mount the bolt cuff aligning per template
Install trim accordingly

Strike Kit

Supplied Standard

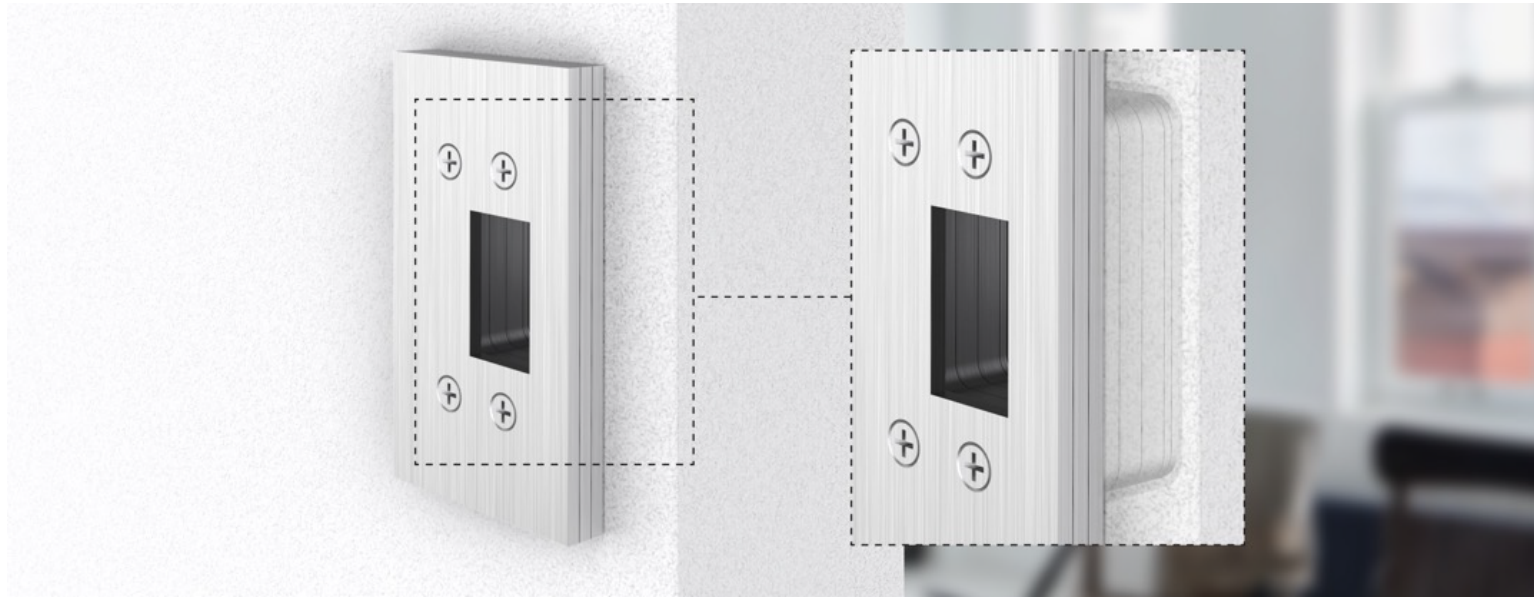

Not to scale

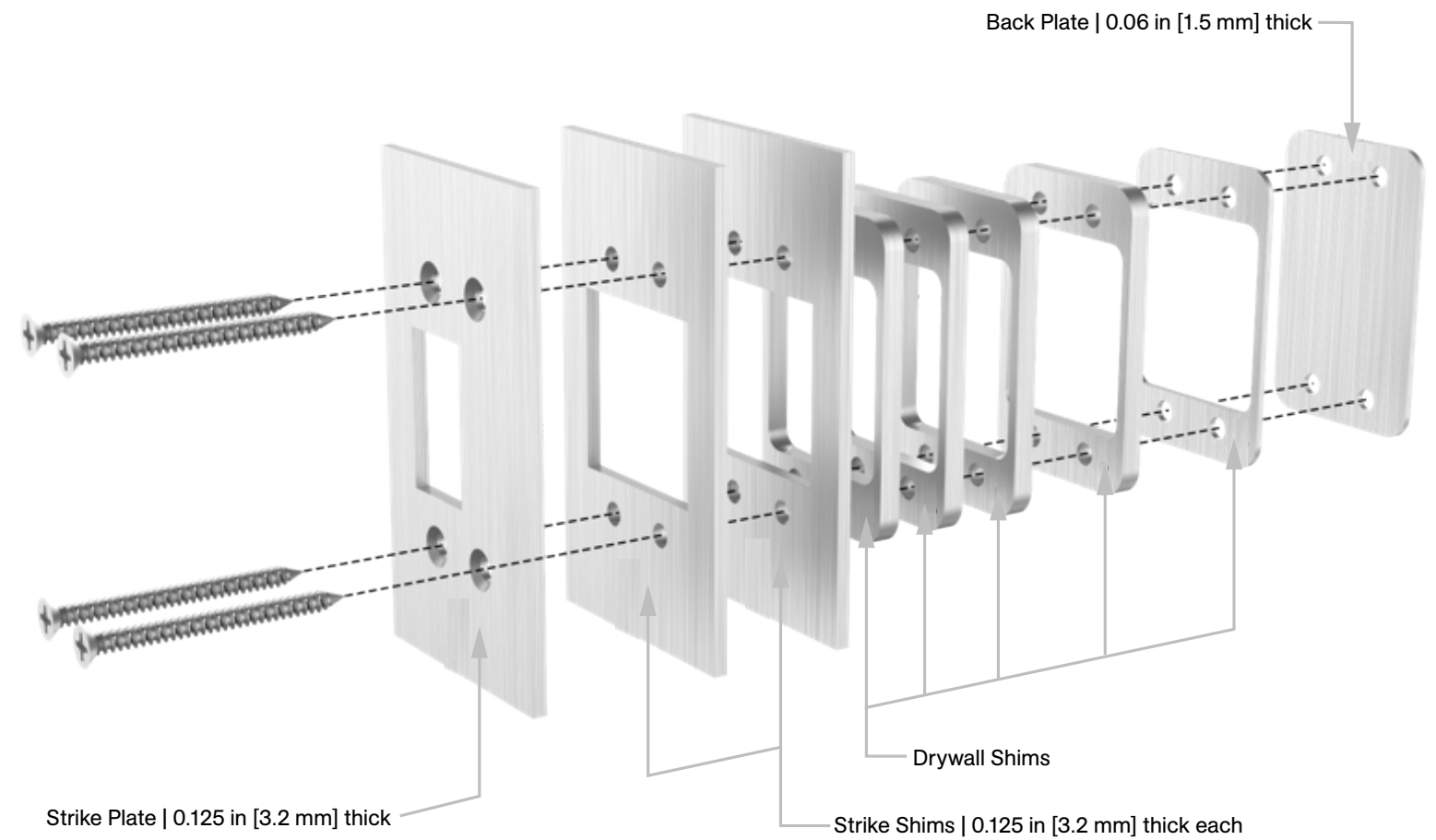
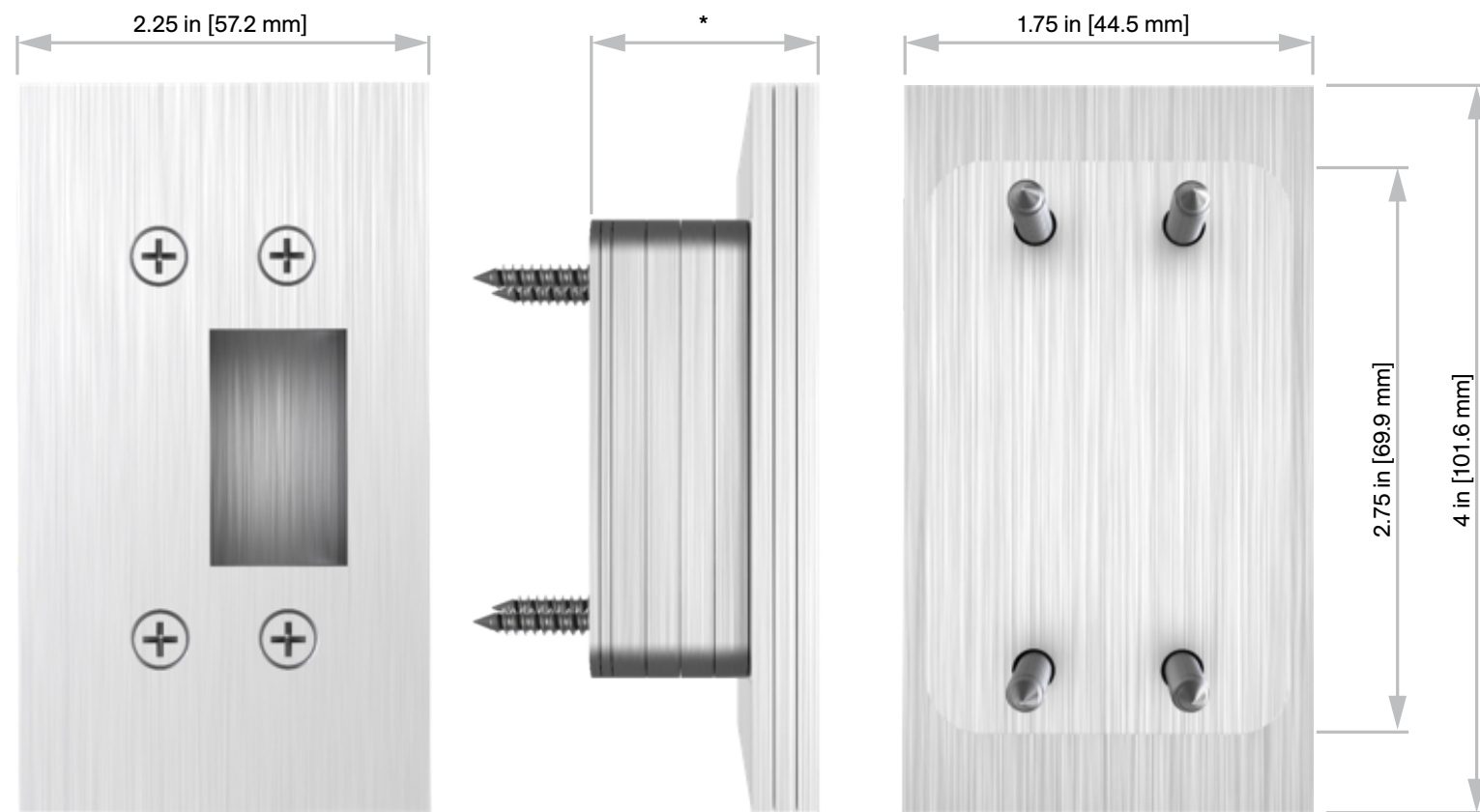

Number of drywall shims used is a function of drywall thickness.

Number of strike shims used is a function of the gap between the face of the door and the wall.