

# CGP-038 Glass Door Pull

Installation Instructions

Glass Thickness: 3/8 in [9.5 mm]

Not to scale

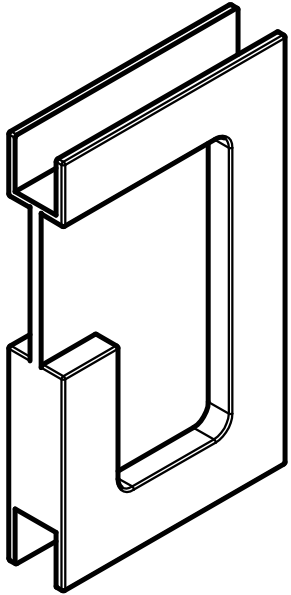

**Step #1:**  
Cut glass as per glass prep on next page.

**Step #2:**  
Fill space between cut line and cross-hatched area with clear epoxy adhesive such as WEICON Easy Mix N-5000 and let dry and harden properly before use.

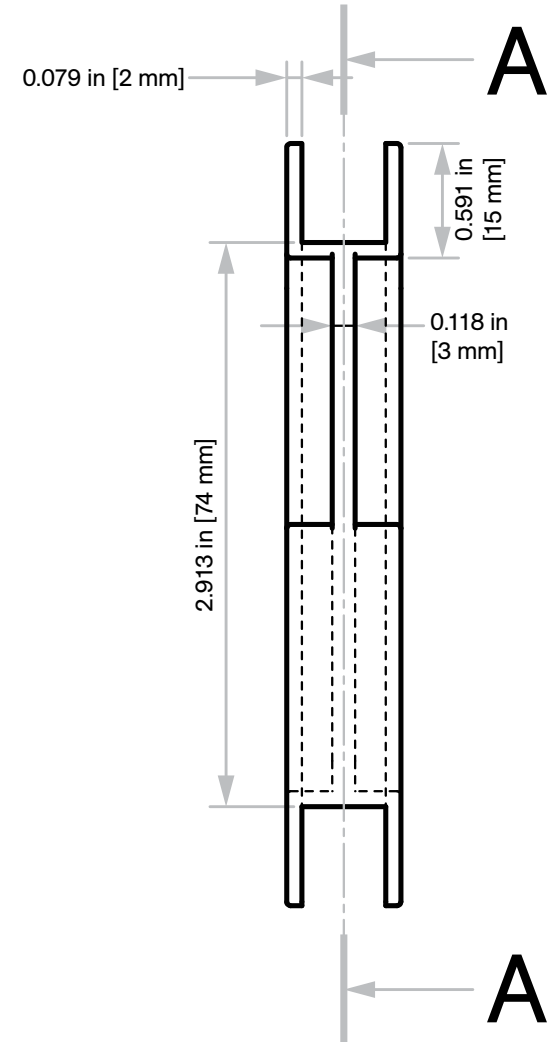
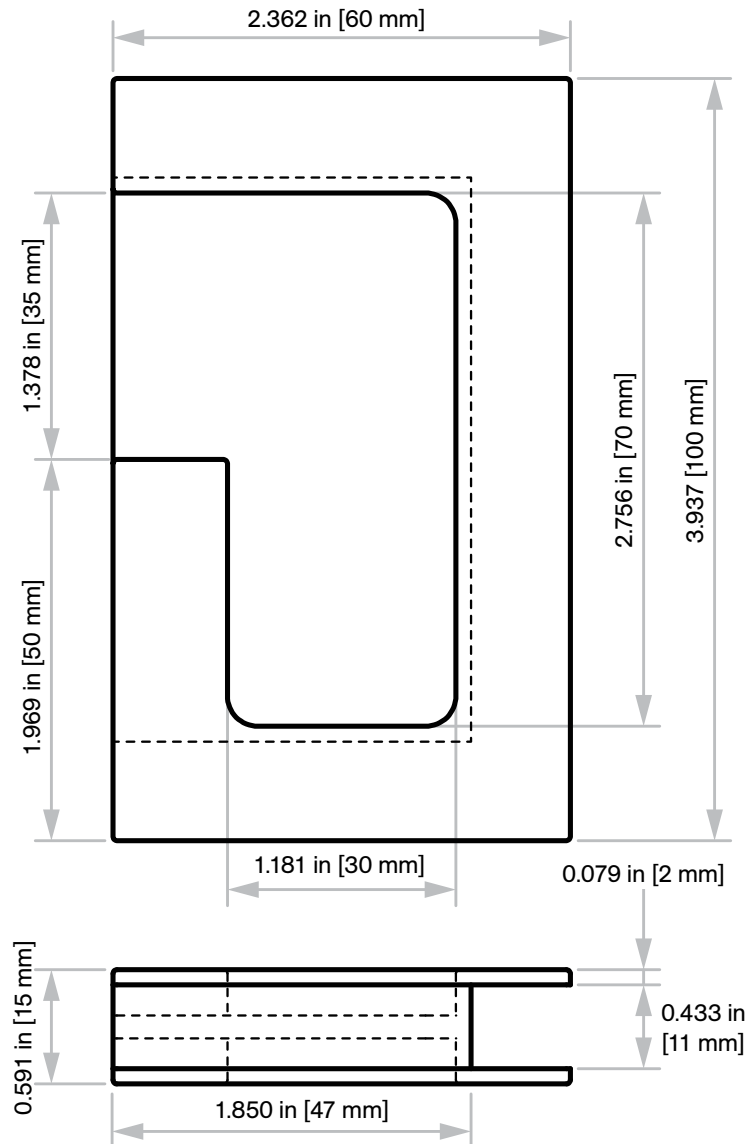

# Glass Prep

Not to scale

With 0.394 in [10 mm] radius cut  
3.15 in [80 mm] x 1.969 in [50 mm]

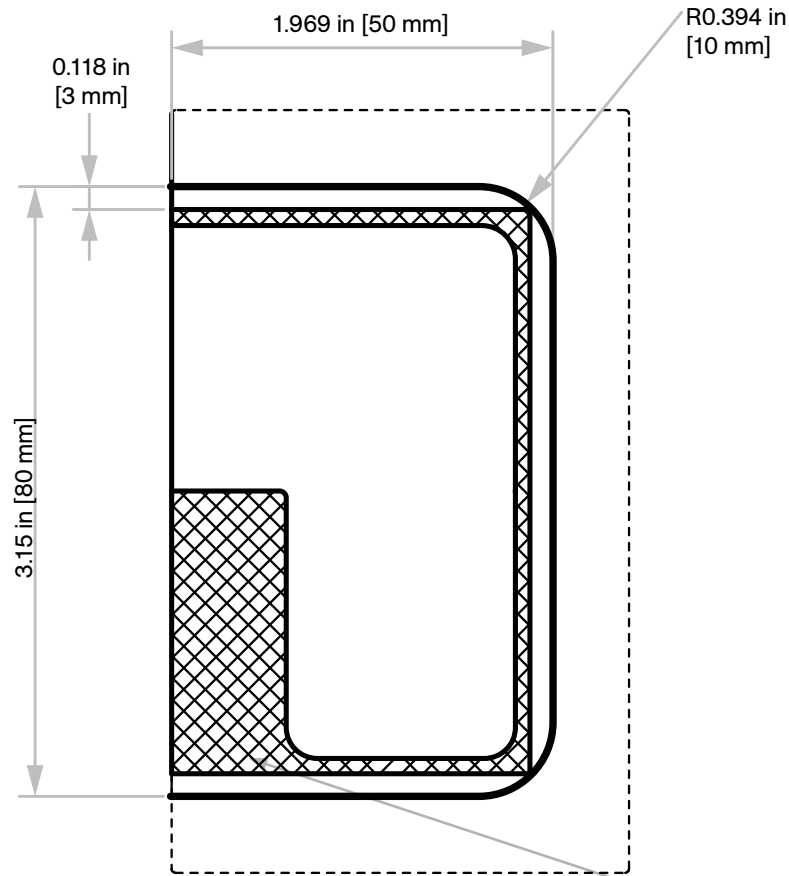

With 0.787 in [20 mm] radius cut  
3.386 in [86 mm] x 2.087 in [53 mm]

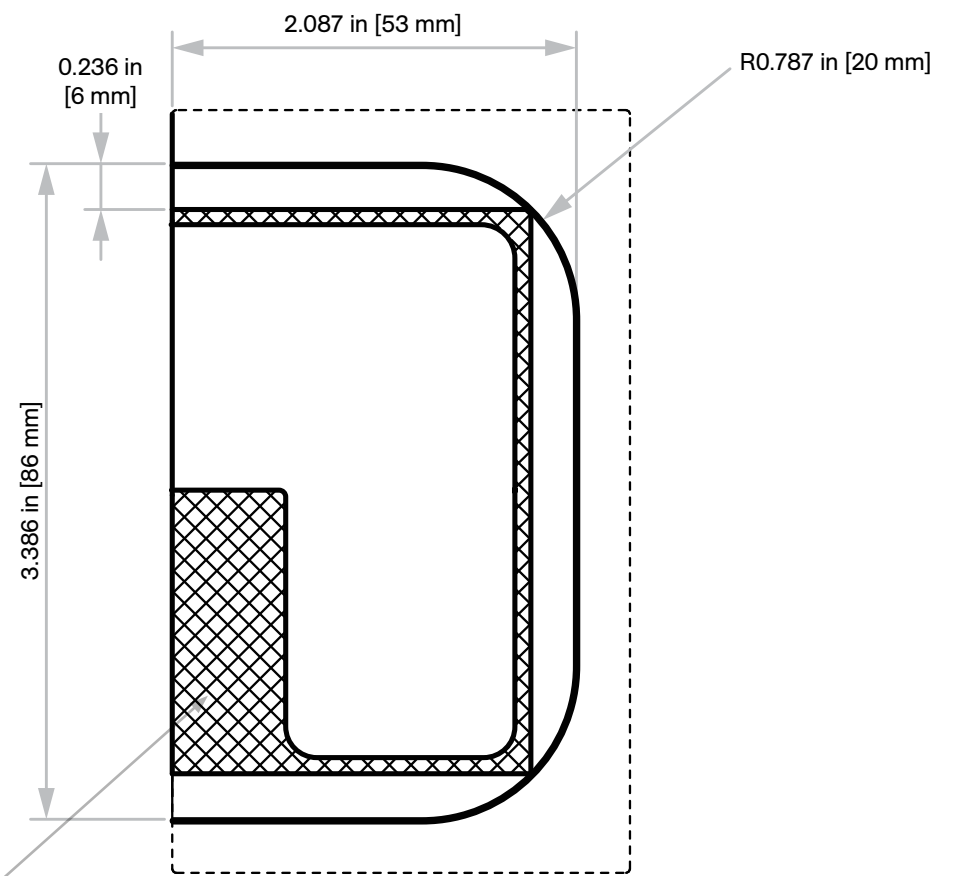

The cross hatched area is the cut A-A